

**FLAVIA | DISHWASHERS**

# **FULLY INTEGRATED DISHWASHER**

## **DELIA**

**BI 45 DELIA**

**BI 60 DELIA**

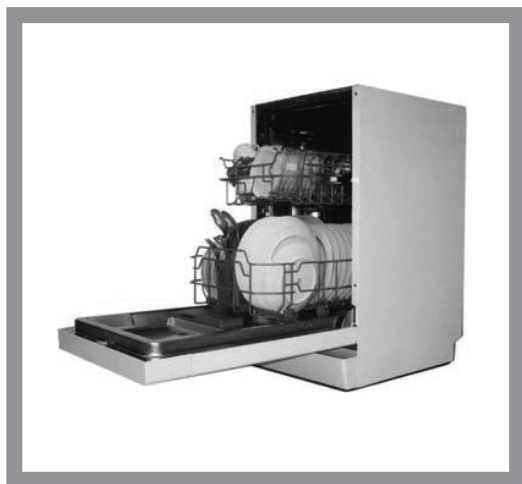

## Operation and installation manual

### Dear customer!

Thank you for buying a “FLAVIA” product. We hope, this appliance will meet your expectations and be a reliable assistant of yours in your kitchen. For correct and safe operation of the appliance, please carefully read all the chapters in the present manual. Keep your manual for the entire service life of the product you have purchased.

Reading the first part of the manual, you will learn some important conditions to ensure safe operation of the appliance. To keep your appliance in good condition for a long time, we offer you a lot of helpful advices on the product care and cleaning. In the manual you can find some hints on energy saving.

On the last pages of the manual you can also read recommendations which will help you remove minor failures, if any, during operation of your appliance.

Your new appliance is made of high-quality materials and fully conforms to any standard of the European Economic Community.

The manufacturer reserves the right to make changes to the product design in order to improve its performance. Our household appliances are subject to continual improvement, the performance is enhanced, and their design is updated. Therefore, drawings and symbols in the manual may differ from those for the model you have purchased.

The manufacturing date is in the serial number of the product. The serial number is on the internal label which is on the side of the dishwasher door.

Serial number explanation:  
1406376200013

<b>14</b> ↓	<b>06</b> ↓	<b>376200013</b> ↓
<b>manufacturing date</b>	<b>manufacturing month</b>	<b>model number</b>

### CONTENTS

Safety hints and statements .....	2
Scope of supply .....	3
Technical data .....	4
Control panel.....	4
Dishwasher design .....	5
Table of operating modes .....	7
Water softener.....	8
Water hardness table .....	9
Detergent agent .....	9
Rinsing agent .....	10
Putting dishes into the dishwasher .....	12
Turning on the appliance.....	13
Filter system.....	14
Dishwasher care .....	15
Installation preparation .....	17
Installation procedure .....	17
Decorative panels sizes and mounting.....	18
Door spring tension adjustment .....	20
Drain hose connection .....	21
Electrical connections .....	21
Universal adapter connection .....	21
Water supply connection.....	22
Dishwasher installation sequence .....	22
INSTALLATION INSTRUCTIONS .....	24
Hints on troubleshooting.....	24
Codes of errors .....	29
What you may not wash using this dishwasher .....	30

The product has been manufactured in line with European standards and is CE, TÜV, ISO 9001 certified.

The manufacturer reserves the right to make changes to the product design in order to improve its performance.

### SAFETY HINTS AND STATEMENTS

#### **Attention!**

**To avoid failures when connecting the appliance in cold months, keep it unpacked at a room temperature within at least 2 hours.**

**When using the appliance, observe safety precautions as follows:**

#### **EARTHING**

The appliance shall be earthed. In the event of a failure or breakdown, earthing will reduce a risk of electrical shock. The appliance is equipped with a cord with an earth wire and earth plug. Plug into a corresponding socket, installed and earthed according to the valid regulations.

**Improper connection of the earth wire may lead to electrical shock. If you doubt, whether earthing is correct, please contact a qualified electrician or representative of the Service Center. Do not make changes to the design of the plug supplied with the appliance. If it doesn't fit for your socket, have the socket replaced for which a professional electrician must be involved.**

#### **ATTENTION!**

Do not break the dishwasher door and dish grid! Do neither sit down nor stand on it!

Do not touch heating elements during heating and right after use.

Do not wash plastic dishes unless they bear a special marking to confirm they may be washed in a dishwasher. If the dishes are unmarked, refer to the manufacturer's recommendations.

Use those washing and rinsing agents specially developed for automated dishwashers. Never use soap, agents for laundry, hand cleaners.

Keep children away from washing agents and the open door of the dishwasher, because after use the dishwasher may contain residuals of washing agents.

Do not leave the door open because you can knock against that. When installing the dishwasher, do not overbend and flatten the electric wire.

Avoid intervention on the control system.

Little children and physically disabled people are not permitted to use the appliance.

All the dishwashing detergents used are alkali-based and very harmful, if swallowed. Avoid contact with eyes and skin; keep children away from the open door of the dishwasher.

Do not switch on the dishwasher unless any protection panel is installed. During use be careful to open the dishwasher door because water may spout.

Do not place heavy objects and do not stand on the door of the dishwasher. The appliance may tip over in that case.

## Operation and installation manual

### When putting dishes:

1) Be careful with sharp objects – put them avoiding damage to the door seal;

2) Put sharp knives with the handle upward to avoid cutting yourself. During use, plastic objects shall not touch the heating elements.

If an electric wire is found to be damaged, this is either the manufacturer or a Service Centre representative to replace it, or any other qualified professional. The measure is to be taken to avoid hazards of any kind.

### Proper disposal of the packaging

Use the dishwasher only according to its intended purpose.

If you are going to remove the dishwasher for maintenance or repair, take off the door of the compartment within which the dishwasher is installed.

Do not leave children unattended, prevent them from playing with the appliance.

Upon completion of the washing cycle, please check, whether the detergent agent container is empty or not.

### SCOPE OF SUPPLY

Your dishwasher is classified as a built-in appliance.

The scope of supply includes as follows:

- dishwasher, 1 piece;
- measuring spoon, 1 piece;
- measuring cup, 1 piece;
- funnel, 1 piece;
- hose holder, 1 piece;
- hardware to fasten the decorative panel onto the dishwasher door, 1 set;
- transparent adhesive foil, 1 piece;
- manual, 1 piece.

\* the scope of supply of the dishwasher is subject to change without prior notice.

### TECHNICAL DATA

The manufacturer's plate to identify the dishwasher model is at the top of the dishwasher door side. Open the door to see that.

Model	BI 45 DELIA	BI 60 DELIA
Overall dimensions, mm:		
Width, mm	448	598
Length (depth):	550 (1150 with the door open)	550 (1150 with the door open)
Height (min. – max.):	815 – 865	
Mains voltage / frequency:	220 – 240 V / 50 Hz	
Power consumption, max., Watt	1930	
Number of sets of dishes to be put in	9	12
Energy Performance class	A++	

### ATTENTION!

Before using the dishwasher for the first time, read the manual to find the best and most suitable mode of its operation.

### CONTROL PANEL

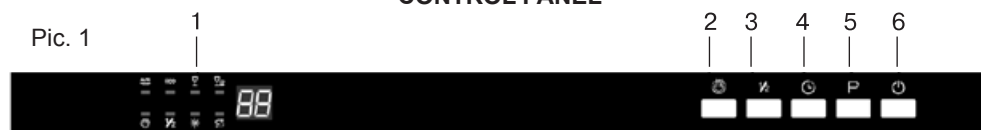

- The display consists of the following elements:
  - rinse aid lack indicator ;
  - salt lack indicator;
  - start delay and error codes;
  - program indicators;
  - additional drying indicator;
  - Half load indicator
- Additional drying function  
Activates the additional drying function (the program, in which this function works - glass, ECO).
- Button for selecting the partial load mode. Turns on the partial loading function, if you need to wash 5 or less sets of dishes. Using this function saves water and energy.
- Washing program delayed start button: the start delay time may range from 1 to 24 hours.
- Button for selecting the wash program.
- Dishwasher on/off switch button.

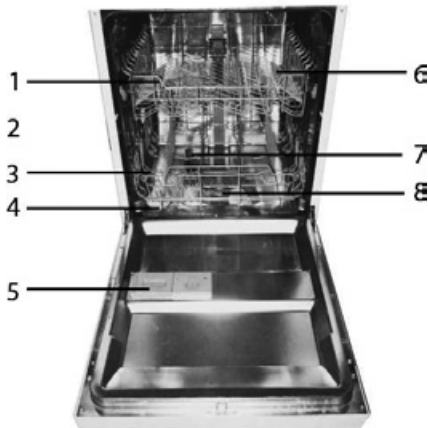

**DISHWASHER DESIGN**

(Picture 2)

1. Upper basket
2. Internal pipe
3. Lower basket
4. Salt container
5. Dosing chamber
6. Cups holder
7. Sprinklers
8. Filtering elements
9. Inlet pipe connecting point
10. Drain pipe
11. Power cable
12. Adjustable rear foot

Pic. 2

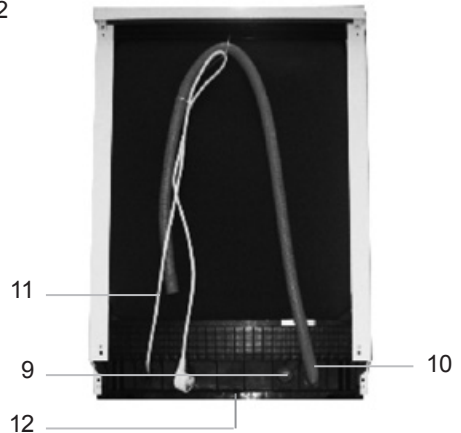

### ATTENTION! IMPORTANT!

**During operation, the dishwasher runs a program selected. The program run time also includes an inactive period, within which it may seem that the dishwasher has completed washing.**

Do not open the door of the dishwasher before the run time of the program selected is up. It is permitted to open the door, if you need to put a plate you've forgotten to put before the start, but you may only do this during injection of the washing (detergent) agent.

The values of various program run times are in the column "Cycle time" in the "Table of operating modes".

A corresponding pictogram is blinking to signal you that the dishwasher is on and runs a program you have selected.

The pictogram is on Display 1, Picture 1, and it blinks during the entire washing cycle.

## Operation and installation manual

A sound signal informs you of the program run completion; the signal is given within approximately 8 seconds. The pictogram of the program selected is off (Display 1, Picture 1).

Should you, for some reason or another, have missed the sound signal to inform you of the program run completion, before opening the door, make sure that the program run has been completed. Look at the pictogram: it must not be blinking, but be off (Picture 1, Position 1). Press Button 5 on the control panel to switch off the appliance, open the door and take out the clean dishes.

**Should you have accidentally opened the door prior to the program run completion, close it at once without pressing any buttons and wait till the program run time is over.**

### **IMPORTANT RECOMMENDATION!**

**To avoid unforeseen events upon washing cycle completion, shut off the water cock to supply water to the dishwasher.**



## Operation and installation manual

Table of operating modes\*

Program	Type of dishes	Information for mode selection	Mode description	Detergent agent consumption: prewashing / washing, g	Washing cycle time, min.	Power consumption for washing cycle, kW/h	Water consumption, L	Rinsing agent
Automatic	Dishware, flatware, big dishes (pots, stewpots, frying pans)	To be used both for moderately and heavily contaminated dishes. Washing and rinsing intensity to be adjusted and controlled automatically	The selection is optimized automatically, for which sensors are used, to measure a contamination level	5/30	120 – 180	0.8 – 1.2	9.2 – 12.4	★
Economy	Dishware and flatware	To be used for slightly contaminated dishes. Minimum water and energy consumption within optimum time	Prewashing Washing 50°C Rinsing 60°C Drying	25 (3 in 1)	165	0.83	9.2	★
Gentle	Glassware (jars, shot and wine glasses), chinaware dishes	To be used for slightly contaminated dishes, with no food residues. 2-hour-mode to include the full washing cycle	Prewashing Washing 40°C Rinsing 60°C Drying	5/30 (3 in 1)	110	0.85	15.0	★
Speed	Dishware and flatware	To be used for slightly contaminated dishes, this is a program to speed up washing by 4 times (with Energy Efficiency Class A+*). Designed for dishes that need no drying	Washing 40°C Rinsing Rinsing 45°C	20	40	0.45	10.0	

★ use of a rinsing agent is obligatory with these modes selected.

\* The table shows calculated values of water temperature. Actual temperatures may differ from calculated ones.

\*\* after the slash: prewashing / washing. The modes are to be selected pressing the PROGRAM SELECTION button. Pressing the button each time you switch to the next program in an order as follows: automatic – ECO – glass – quick

### WATER SOFTENER



There are two methods to soften water: either with a softener, or a washing agent.

Water hardness values may vary from place to place. If your dishwasher uses hard water, this may lead to formation of scale and deposits on dishes.

The appliance is equipped with a special softener to use salt, specially developed for removal of lime and minerals from water.

### HOW TO CHARGE SALT INTO THE SOFTENER

Make sure to always use salts meant for dishwashers only.

The salt container is beneath the lower grid. The way to fill it in is as follows:

1. Remove the lower basket, unscrew the salt container cover to remove that.
2. If you fill in the container for the first time, fill it with water (2/3 of the vol.).
3. Insert the funnel end (included), charge approximately 1.5 kg of salt. It is normal, if some water flows out of the container.
4. Carefully screw in the cover.

### NOTE:

1. The salt container should be refilled, when the “**S**” pictogram (upper left corner of the display) starts to illuminate. Even if the container is properly filled, the pictogram may still illuminate until salt is dissolved completely.
2. If you have spilled the salt, you can wash it out, using the “**Quick**” program

### SALT CONSUMPTION CONTROL

The list of the dishwasher functions also includes the salt consumption control, depending upon water hardness. This is to optimize salt consumption, and you can control it in the following way:

1. Press the ON / OFF button.
2. Press and hold (60 sec) the program selection button. Wait for the sign H1 (or H2, H3 or H4) to be displayed. At that, salt and rinsing agent indicators will blink.
3. Pressing the program selection button, select desired salt dosage, depending upon water hardness (see the “Water hardness table”). With each touch of the button you switch to the next mode: H1-H2-H3-H4-H5-H6.
4. To complete selection, press the ON/OFF button.

These settings are required each time you disconnect the dishwasher from the mains.

You may be informed of water hardness in your location at local authorities or upon a lab research of a water sample.

## Operation and installation manual

Water hardness		Settings	Display indication
°dH <sup>1)</sup>	mmol/l <sup>2)</sup>		
0 – 5	0 – 0.09	1	H1
6 – 11	1.0 – 2.0	2	H2
12 – 17	2.1 – 3.0	3	H3
18 – 22	3.1 – 4.0	4*	H4
23 – 34	4.1 – 6.1	5	H5
35 – 45	6.2 – 8.0	6	H6

<sup>1)</sup> Water hardness MU in Germany

<sup>2)</sup> Internationally accepted MU of water hardness

\* factory setting

### DETERGENT AGENT

#### ATTENTION!

**Detergent agents are very caustic!  
Keep them away from children!**

The dosing chamber must be filled in before start of each washing cycle, according to instructions from the “Table of operation modes”. Your dishwasher consumes less washing and rinsing agents, as opposed to conventional appliances of that kind. For a normal (standard) washing cycle, a table spoon of the detergent agent is enough. For heavily contaminated dishes you should use a larger quantity of the detergent agent. Always add the detergent agent right before washing, otherwise it may get soaked, without dissolving completely.

#### Proper use of detergent agents

Use special detergent agents only. Keep them in a dry place. Charge the detergent

powder into the dosing chamber right before you start washing.

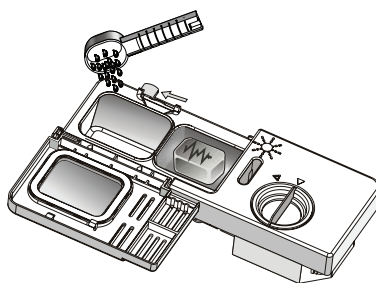

#### Tableted detergent agents

Tableted detergent agents of different manufacturers have different dissolution rates. Due to this, during short programs, tablets may not dissolve completely. As a consequence, this would reduce their cleaning ability. Tableted detergent agents are better used in “intensive” modes, and that is to ensure their complete dissolution.

### Detergent agent consumption

**IF WATER USED IS TOO HARD, YOU MAY AVOID FORMATION OF SCALES AND DEPOSITS, ADDING A WASHING AGENT!**

An amount of the detergent agent used may vary, depending upon water hardness.

To be informed of this value, please contact the local department of water resources. For harder water you will need a larger amount of the detergent agent. Keep in mind that you should select an appropriate amount, slightly changing it with small portions, until you find a proper dosage according to water hardness in your location.

### Descaling

To remove scales, do the following:

- Wash the dishes using a standard ("normal") program.
- Take any metal dishes, flatware, spots, etc. out of the dishwasher.
- Do not add any detergent agent any more.
- Fill in 2 table spoons of vinegar into a little bowl and place it upon the lower grid within the dishwasher.
- Run "Standard" program.

If this doesn't work, repeat the same, using  $\frac{1}{4}$  glass of citric acid crystals instead of vinegar.

### RINSING AGENT

This is to be used at the last stage to prevent drop marks on dishes. This also improves drying, enabling water to "run off" the surface of dishes.

Your dishwasher uses liquid rinsing agents. The rinsing agents doser is inside, close to the dosage chamber of the detergent agent. To fill in the doser, open the cover and fill in water, till the level indicator turns black.



- To open the doser cover, turn it to the left ("Open" position) and remove it.
- Fill in the doser with you rinsing agent. Do not overfill!
- Close the cover, turning it to the right.

Do not overfill the doser, for it may result in excessive soaping. If you spill some, wipe it with a soft cloth. Prior to opening the door, do not forget to screw the cover.

## Operation and installation manual

### Rinsing agent doser control

Within the last rinsing cycle, a certain amount of the rinsing agent is used. Similar to use of the detergent agent, the quantity of the rinsing agent depends upon water hardness. If you use too much rinsing agent, this may lead to excessive foaming and occurrence of stains on your dishes. If water in your location is soft, you will need no rinsing agent. But if you still need that, dilute it with a corresponding amount of water.

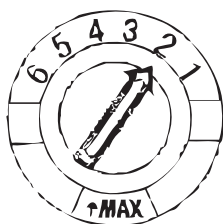

The doser has 6 positions. Always start with Position 2. If the dishes dry out badly, if there are drop marks on them, increase the amount of the rinsing agent, switching to Position 3. Continue to increase the amount, till there are no drop marks on your dishes. We recommend using Position 4.

### How to fill in the doser with the rinsing agent

If the control panel does not include an agent level control lamp, you can calculate a required amount of the rinsing agent in the following way. The black spot decreases in size with the liquid volume decrease. The level below  $\frac{1}{4}$  is not permitted.

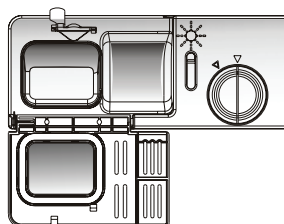

Depending upon consumption of the rinsing agent, the size of the black spot decreases in size (see the figure):

- Full
- $\frac{3}{4}$
- $\frac{1}{2}$
- $\frac{1}{4}$  - refilling required
- Empty

## Operation and installation manual

### PUTTING IN DISHES

#### Loading the upper basket

The upper basket is designed for light and fragile dishes – glasses, coffee and tea cups and saucers, as well as plates, small salad bowls and flat baking sheets (if they are not too dirty). Place the dishes so that it does not move with jets of water.

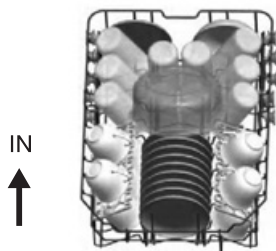

#### Loading the lower basket

We recommend you to put larger dishware items, as well as those heavily contaminated, into the lower basket of the dishwasher. These would include as follows: spots, pans, covers, serving dishes and plates, as shown in the figure below.



It is preferred to place serving dishes and plates on the edges of the basket not to cause interference with free rotation of the upper water sprayer.

#### Please, keep in mind:

- Spots and serving dishes and plates must be put bottom up.
- Deep spots must be put inclined, so that water can run off.
- The lower basket features drop walls and enables to put larger spots and pans.

#### Putting in dishes

Your dishwasher can hold 10 sets of dishes. The upper basket is designed for light and fragile dishes. Place the dishes so that it does not move with jets of water.

Depending on the model, the upper basket can be equipped with short levers, with which you can easily adjust the height of the upper basket even with put in dishes.

If there are no such levers, you can adjust the height of the basket before putting in the dishes, by removing the caps from the guides and moving the basket to the desired level.

#### Folding board



Position 1



Position 1

## Operation and installation manual

### Hinged cups holders

To optimally place spots and pans you can fold teeth, as shown in the figure on your right.

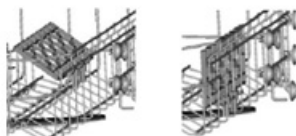

### Basket for table-ware

The table-ware shall be placed into the basket with handles downwards. If there are side baskets, spoons shall be placed separately, into special slots. Longer kitchenware items shall be laid horizontally, at the front of the basket, as shown in the figure.

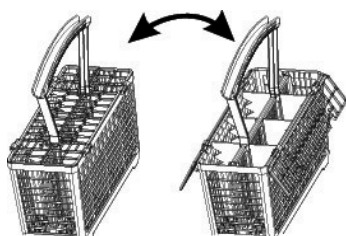

To ensure high quality washing, prior to placing the silverware make sure as follows:

- All items are separate (not put one into another).
- Silverware items are placed with handles upwards.
- Longer items of the kitchenware are in the middle.

## SWITCHING ON THE APPLIANCE

### Starting a washing cycle

1. Make sure the dishwasher is connected to the mains.
2. Make sure the water cock is opened all the way.
3. Put your dishes (See "Putting the dishes").
4. Fill in rinsing and detergent agents (See "Detergent agents" and "Rinsing agents").
5. Open the door, press ON / OFF button.
6. Press the program selection button, select a washing cycle desired (See "Table of operating modes").
7. Shut the door. Washing begins in 10 sec.

### ATTENTION:

If you open the door of the dishwasher with a program running, the program execution may be interrupted and stopped. The visual control function will, correspondingly, turn off. Upon closing the door, when the program will continue, the luminous point will appear on the floor again.

### Program changes or cancellation

Note: a started cycle may only be changed, if the dishwasher operates for a very short time. Otherwise, the detergent agent may already be released, and the dishwasher has started supplying water. If that has already

## Operation and installation manual

happened, please refill the detergent agent doser (See "Detergent agents"). Open the door, press and hold the program selection mode 3 sec at least. After that you can switch to any program desired. Close the door.

### Upon completion of the washing cycle

Upon completion of washing, a sound signal will be given within 8 sec. Switch off the appliance, pressing the ON / OFF button. Open the door. Wait several minutes to let the dishes cool down. After that take them all out of the dishwasher.

### Forgot to put a plate?

You may put a forgotten plate prior to injection of the detergent agent..

1. Slightly open the door to stop the washing cycle.
2. After water nozzles have stopped operating, open the door all the way.
3. Put the forgotten plate.
4. Shut the door. The dishwasher will restart in 10 sec.

#### ATTENTION!

**It is dangerous to open the door of the dishwasher in operation due to a possible contact with hot water!**

### FILTER SYSTEM

The filter is within convenient reach. The filter system includes three components: main filter, coarse filter and fine filter.

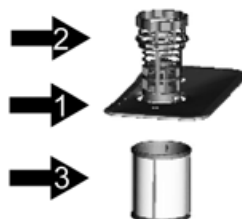

#### 1. Main filter.

Food and dirt residues, screened with this filter, are washed down by means of water jet from the lower nozzle.

#### 2. Coarse filter.

Bigger particles, such as bones and pieces of broken glass, that may clog discharge pipes, are screened with the coarse filter. To remove particles, screened with it, carefully squeeze the upper tags and take out the filter.

#### 3. Fine filter.

This is designed to screen dirt and food residues and prevent their contact with dishes during the washing cycle.

#### ATTENTION!

**Do not turn the fine filter upside down!**

### DISHWASHER CARE

To clean the control panel, use a slightly wet cloth. Then wipe the surface dry. To clean other surfaces use light polishing. **Never use sharp objects or hard sponges to clean the dishwasher surfaces.**

#### Protection against freezing

If you are going to keep your dishwasher in a cold room during winter, ask service engineers to do the following:



## Operation and installation manual

1. Disconnect the dishwasher, remove the fuses.
2. Shut off the water supply cock, disconnect the delivery hose and inlet valve.
3. Drain water from the delivery hose and inlet valve.
4. Connect the hose and valve again.
5. Take out the filter body and remove water using a sponge.

### Cleaning moving nozzles



The moving nozzles must be cleaned on a regular basis, otherwise scales and hard water deposits will clog them, as well as water channels. For that, unscrew the nut, remove the upper part of the mover. After that remove the nozzles. Wash the nozzles in warm soapy water, use a soft brush to clean their openings.

### Filter cleaning

To ensure the best results, you should clean the filter system on a regular basis.

The filter effectively removes food particles during a washing cycle, enabling water to circulate. For this reason, the best thing is to remove larger particles after each washing cycle, washing the filter with running water.

To remove the filter (see the drawing below), turn the upper part of the filter box counterclockwise. Then, remove the coarse and fine filters. The filter system is subject to cleaning on a regular basis, once a month at least.

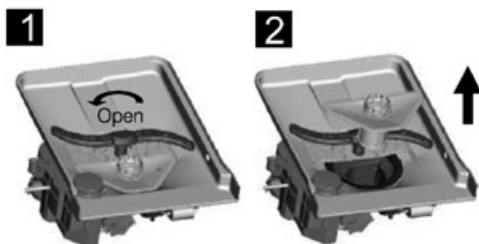

1. Turn the filter counterclockwise.
2. Remove the filter.

The assembly procedure is carried out in reversed order.

Use a brush to clean the coarse and fine filters. Then, assemble the entire system and insert that into the dishwasher, to positions corresponding, slightly pushing the system.

It is prohibited to use and operate the dishwasher without the filter. Improper installation of the filter may result in deterioration of the dishwasher performance and damage to dishes.

### ATTENTION!

**Never use the dishwasher without the filter!**

### Cleaning the door

To clean the door edges, you should use a piece of soft and wet cloth.

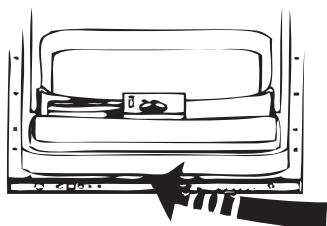

### ATTENTION!

**Never use sprays to clean the door panel! This can damage the lock and electrical components. It is also not permitted to use abrasives and some kinds of paper towels because they can scratch the surface and leave marks on it.**

### Dishwasher care

After each washing cycle shut off the water supply cock and leave the door a bit open to remove moisture and odors. Disconnect the dishwasher. Always unplug the dishwasher before cleaning and maintenance! Do not risk! Never use any solvents and abrasives to clean exterior parts and rubber components of the dishwasher. You better use a piece of cloth and warm soapy water. To remove stains on surfaces use a piece of cloth, water and a small amount of white vinegar, or a special cleaning agent developed for dishwashers.

### If you go off on holiday

If you are going to be away on holiday, we recommend you to start a washing cycle without dishes. After that you have to disconnect the appliance, shut off water supply and leave the door a bit open. This would keep the seals in proper condition and prevent formation of odors inside the appliance.

### Moving the dishwasher

Should you need to move the dishwasher, try to keep it in a vertical position, or with the back cover downwards at least.

**PLEASE CAREFULLY READ  
THE PRESENT MANUAL.  
THIS CONTAINS INFORMATION THAT  
WILL HELP YOU UNDERSTAND IN-  
STALLATION PROCEDURES AND  
FIND THE BEST PLACE TO INSTALL  
YOUR DISHWASHER.**

## INSTALLATION PREPARATION

The dishwasher must be installed in close vicinity to available water supply and discharge points, as well as a socket.

One of the walls of pieces of furniture must be selected for connection of an inlet and drain hoses of the dishwasher.

## INSTALLATION

**Note:**

check whether all hardware items are available, required for installation of a dishwasher (fasteners, screws for a decorative panel).

1. Choose a convenient place, where water is supplied and discharged. Connect the inlet and drain hoses (Fig. 1).
2. If you place the dishwasher in a corner piece of furniture, the minimum distance between the side part of the open door and kitchen furniture shall be 50 mm (Fig. 2).

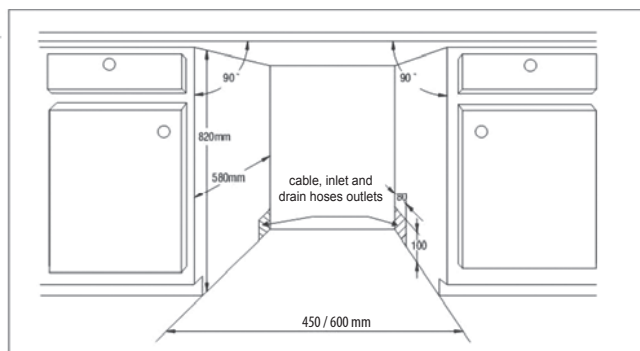

Figure 1. Dimensions and general view of a recess for the dishwasher installation.

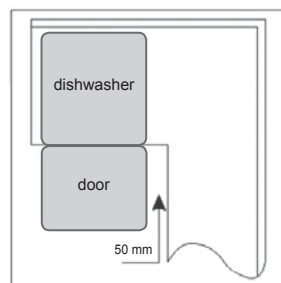

Figure 2. Top view.  
Minimum space with  
the door open

### DECORATIVE PANEL DIMENSIONS AND MOUNTING PROCEDURE

#### Preparation

1. The decorative wooden panel to be attached to the door of the dishwasher shall be prepared according to drawings as shown in Figures 3a and 3b.

2. Place the fixtures onto the decorative panel, fasten the panel to the door using them (Figure 4a).

Upon mounting the decorative panel, use the screws to finally fix that (Figure 4b).

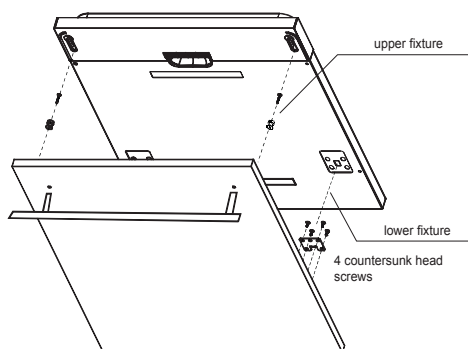

Figure 4a. Mounting the decorative panel

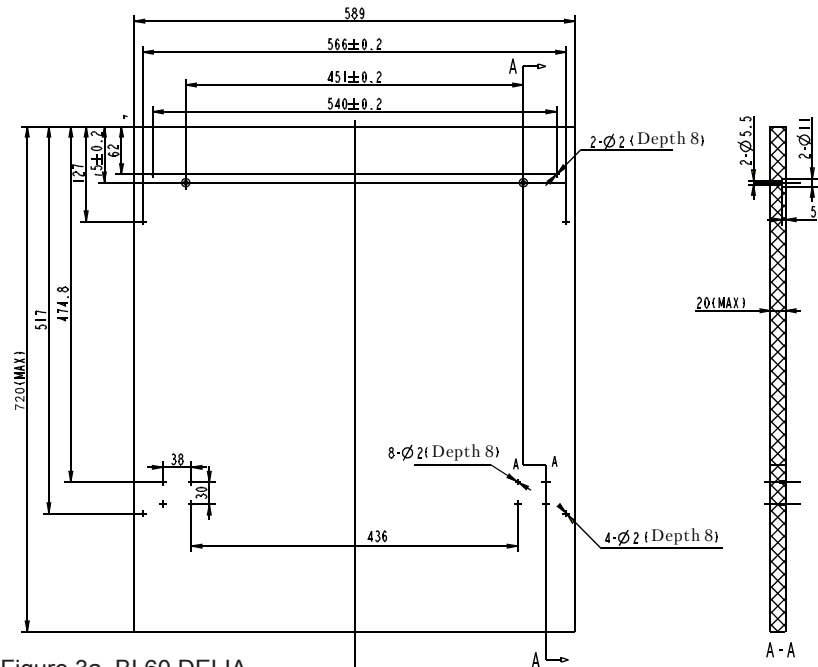

Figure 3a. BI 60 DELIA.

## Operation and installation manual

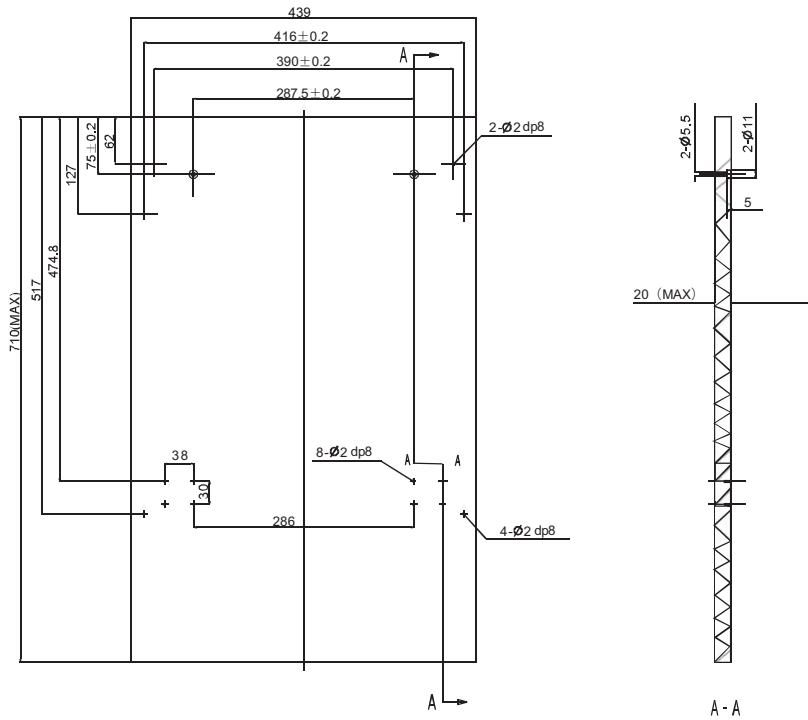

Figure 3b. BI 45 DELIA.

### DOOR SPRING TENSION ADJUSTMENT

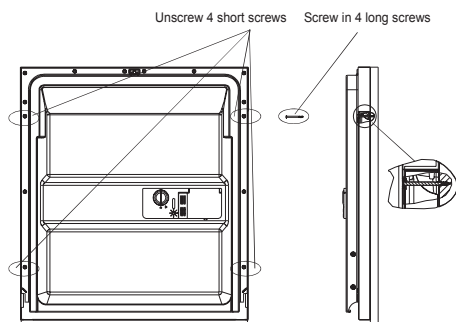

Figure 4b. Fastening the decorative wooden panel.

The door spring tension adjustment is factory-made, to parameters required. If you mount the decorative wooden panel, you will have to readjust the spring tension. Rotate the screws to increase the steel cable tension or release it.

The door spring is tensioned properly, if the door remains in a horizontal position when fully open, and a gentle push with a finger is enough to lift and close it.

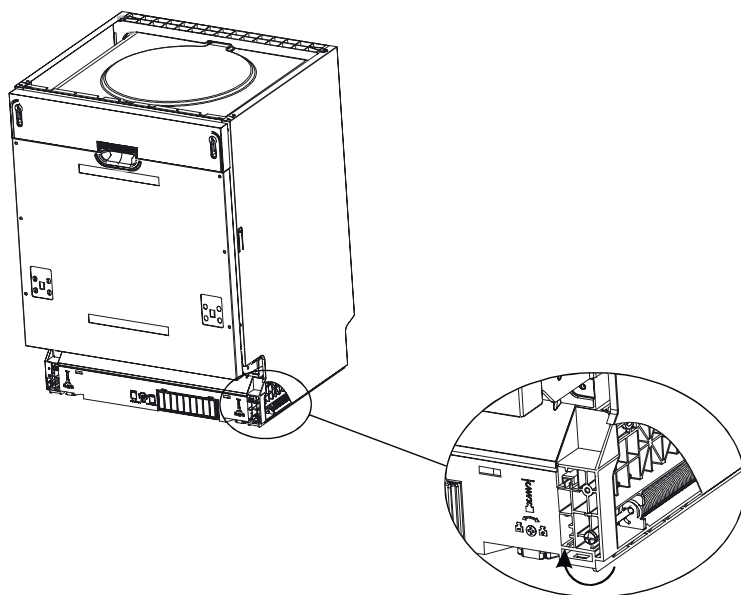

Figure 5. Door spring tension adjustment.

## Operation and installation manual

### DRAIN HOSE CONNECTION

Insert the drain hose into a drain opening, minimum diameter 4 cm, check, if there are any bends. As it may be required, use a special fastener, which is included (Fig. 6). The free end of the hose may be positioned at a height ranging from 40 cm to 1 m. Do not dip it into water.

#### ATTENTION!

**Be sure to properly fix the plastic fastener because the hose mustn't be loose. Failing to do this may result in water splashing.**

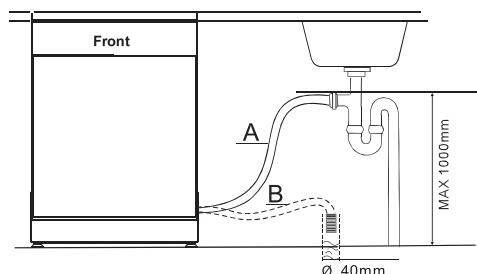

Figure 6. Drain hose connection.

### ELECTRICAL CONNECTIONS

#### ATTENTION!

**NEVER USE EXTENSION CABLES AND CONNECTING ADAPTERS FOR THIS APPLIANCE! UNDER NO CIRCUMSTANCES DISCONNECT THE GROUND PLUG FROM THE WIRE.**

#### Requirements for electrical connections

Please, look through the table to contain power values to find out the voltage and

connect your dishwasher to a power supply source. Use a 15 A fuse. Use copper wires only! It is recommended to use a time-delay fuse and circuit breaker.

The socket must be close to the appliance.

#### ATTENTION!

**Check the earthing before use.**

Make sure that the mains voltage value conforms to that one in the manufacturer's plate. Plug in (the socket must be grounded, too). If the socket doesn't suit for the plug, you better replace the socket other than use any connecting adapters, because these may overheat and burn.

### U-JOINT CONNECTION

#### How to connect a U-joint

There is a new U-joint to be used to connect the appliance to a water supply source. Water pressure values may range from 0.04 to 1 MPa. If the water pressure is below a minimum value, contact a representative of your service center.

1. Pull the U-joint and all its hoses from the compartment on the rear wall of the dishwasher.
2. Attach the U-joint to the water cock, using  $\frac{3}{4}$ " screws.
3. Turn the water cock all the way to open it before starting the dishwasher.

## Operation and installation manual

### Safe inlet hose

The safe inlet hose has two walls. The hose system activates and shuts off water supply in the event of damage to the inlet hose, or if air space between the inlet hose and external corrugated hose is filled with water.

### How to disconnect the U-joint from the adapter

1. Shut off water supply.
2. Increase water pressure, slightly unscrewing the hose nut. This will prevent water splashing.
3. Remove the U-joint from the water cock, squeezing the clamp on the upper part of the U-joint.

### How to disconnect the dishwasher

1. Unplug the dishwasher.
2. Disconnect the U-joint from the cock adapter.

**NOTE:**  
upon completion of the last rinsing, you may remove the U-joint and store it.

## WATER CONNECTION

### ATTENTION!

**USE NEW HOSES ONLY! REPEATED USE OF HOSES USED BEFORE IS NOT PERMITTED. WATER PRESSURE VALUES MAY RANGE FROM 0.04 TO 1.00 MPA.**

### Cold water connection

Connect the cold water supply hose to a threaded  $\frac{3}{4}$ " adapter and make sure it is

tight. If water supply pipes are new or have not been used for a long time, let water run-off and check whether it is clean and contains any impurities. Failing to do so, may result in clogging the inlet valve and, as a consequence, dishwasher breakdown.

### ATTENTION!

**Your dishwasher may only be connected to a cold water supply source. Hot water connection is expressly prohibited.**

## DISHWASHER INSTALLATION SEQUENCE

1. Fasten a decorative door of your piece of furniture to the door of your dishwasher, using special fixtures (Item 1, Figure 7).
2. Adjust the door spring tension, using a box wrench, turning it clockwise to tighten up the spring and counterclockwise to release its tension. Failing to do so, may result in breakdown of the dishwasher (Item 2, Figure 7).
3. Connect the inlet hose to a cold water supply source.
4. Connect the drain hose (see Figure 6).
5. Connect the appliance to the mains.
6. Mount the dishwasher onto the guides (Item 4, Figure 7).
7. To protect the tabletop from condensate, apply transparent adhesive foil (included) onto the reverse side of the tabletop (to cover the entire area above the dishwasher door).



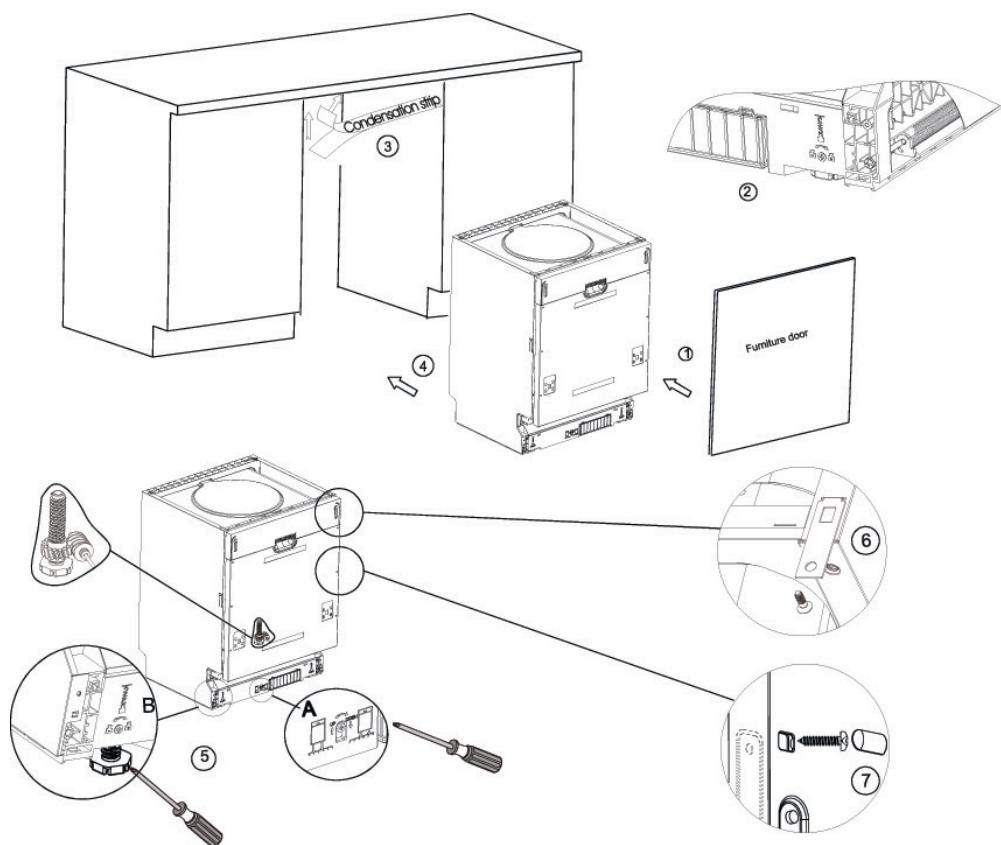

Figure 7. Dishwasher installation sequence

8. Bring the dishwasher into a position described.
9. Level the dishwasher. Rear feet may be adjusted using screws, located in front (Item 6a, Figure 7). Adjust the front feet using a wrench (Item 6b, Figure 7).
10. The dishwasher must be fixed in its position. There are 2 ways to do it:
  - A. If your tabletop is made of wood or chip board, attach the dishwasher to it, using wood screws. Be careful because the weight load can draw the screws from wood (Item 7, Figure 7).
  - B. If your tabletop is made of marble or granite, fasten the dishwasher to wall of adjoining pieces of furniture. Cover the heads of screws with rubber caps to avoid damage to the tabletop surface (Item 8, Figure 7).

## INSTALLATION INSTRUCTIONS

The dishwasher must be level which is to ensure its proper functioning.

1. Place a water level onto the door and lower rail to level the dishwasher.
2. The dishwasher design enables to adjust the feet, using the screws in front (Figure 7).
  - 2.1. "A" marking: screws to adjust the rear feet.
  - 2.2. "B" marking: screws to adjust the front feet.
3. Be careful when adjusting the feet: do not fully unscrew them out of the dishwasher body!

## HINTS ON TROUBLESHOOTING

Problem	Possible causes	Remedies
The dishwasher is out of service	Blown fuse, or safety plugs off	Replace the fuse, switch on the safety plugs. Disconnect any other appliances that use the same socket
	No power supply	Make sure the dishwasher is connected to the mains. Make sure the dishwasher is properly plugged in.
	Low water pressure	Make sure all hoses are properly connected

# DISHWASHERS

## Operation and installation manual

Problem	Possible causes	Remedies
The drain pump can't be switched off	Overfill	The system detects overfill. If any, the circulating pump is off, and the drain pump is on.
Noise	Some natural noise	Noise due to crushing of soft food residues, or noise originating from opening the doser cover.
	Flatware is not fixed in the basket, or there is a very little subject inside it	Make sure all the dishware items are properly fixed within the basket.
	Motor noise	The dishwasher is used on rare occasions. If this is really the case, fill it in with water once a week and discharge it. This would keep the seals wet.
Soap suds in the settlement chamber	Improper detergent agent	Use specially developed agents only. If soap suds are detected, open the dishwasher and let them settle. Add 4.5 l cold water into the settlement chamber. Close the door, select one of the short programs, start the dishwasher. Repeat the same as required.
	Spilled rinsing agent	Wipe it at once, if spilled.
Settlement chamber stained	Detergent agent with coloring matter used	Use detergent agents with no coloring matters.
Wet dishware	The rinsing agent doser is empty	Fill in the rinsing agent doser.
Dirty dishware	Improper program	Select another program for a more intensive washing
	Grid improperly loaded	Make sure larger dishware items do not interfere with operation of the moving nozzles.

## DISHWASHERS

Problem	Possible causes	Remedies
Stains on glasses and flatware	<ol style="list-style-type: none"> <li>1. Too hard water</li> <li>2. Low temperature of inlet water</li> <li>3. Dishwasher overload</li> <li>4. Improper loading</li> <li>5. Old or wet detergent agent</li> <li>6. Rinsing agent doser empty</li> <li>7. Improper dosage of detergent agent</li> </ol>	<p>To remove stains on glass items do as follows:</p> <ol style="list-style-type: none"> <li>1. Take all metal dishware items out of the dishwasher.</li> <li>2. Do not add detergent agent.</li> <li>3. Select the longest washing cycle.</li> <li>4. Start the dishwasher; let it be in operation for 18 – 22 minutes longer than the standard cycle.</li> <li>5. Open the door, pour 2 cups of white vinegar onto the dishwasher bottom.</li> <li>6. Close the door, let the dishwasher complete the washing cycle. If this does not work with white vinegar, repeat the same, but use ¼ cup of citric acid crystals.</li> </ol>
Glassware turbidity	Soft water combined with a too large amount of detergent agent	Use a lesser amount of detergent agent (if water in your location is soft). Select the longest washing cycle to wash the glassware.
Yellow or brown film on surfaces inside the dishwasher	Tea or coffee stains	Use ½ cup of whitener and 3 cups of water to manually remove the stains on surfaces inside the dishwasher.
<div style="background-color: #d3d3d3; padding: 10px; border-radius: 10px; text-align: center;"> <b>ATTENTION!</b>   <b>Wait 20 minutes after the dishwasher stops. Let it cool down before cleaning, otherwise you can burn yourself.</b> </div>		
	Films may form due to ferrous deposits	You have to purchase a special water filter.

# DISHWASHERS

## Operation and installation manual

Problem	Possible causes	Remedies
The doser cover can't be closed	Position OFF not selected	Select OFF position, move the door lock to the left.
Detergent agent residues in the doser	Dishware blocks the doser	Place the dishware in a proper way.
Vapors	Normal occurrence	Small amounts of vapors escape via an opening close to the door lock (during drying and water discharging).
Black or grey marks on dishware	Alu dishware was in contact with other dishware items	Use semi-abrasive agents to remove these marks.
Water remains at the bottom of settlement chamber	Normal occurrence	Some water at the bottom of the settlement chamber helps keep the seals wet.
Dishwasher leakage	Doser overfilled, or rinsing agent spilled	Be careful, do not spill the rinsing agent. Its spillage may result in excessive foam formation and overfill. If spilled, wipe it using a piece of cloth.
	Dishwasher not levelled	Level the dishwasher using a water level.

## Service codes

Problem	Possible causes	Remedies
E1	Problems with water supply to the dishwasher	Check if the water cock is open. Check if the hose is bent. Check if the drain is clogged.
E4	Overfill	Check seals of the dishwasher door. Check if the dishwasher is levelled horizontally. Check if the rinsing agent is overfilled. Check the quality of the detergent agent used (excessive foam formation must be avoided).

### WHAT YOU MAY NOT WASH IN YOUR DISHWASHER

- flat- and table-ware made of wood (wholly or partially) because their colors may fade, and the dishware may lose its attractive look;
- dishware with handles made of bronze and horns;
- fragile / decorative glassware and vases, ancient chinaware – machine washing may damage their decorative paintings;
- plastic dishware, non-resistant to hot water;
- copper and tin-ware, items made of aluminum and silver;
- some kinds of glassware may lose transparency upon several washing cycles;
- never put objects made of absorbing materials into your dishwasher (sponges, towels, etc.).

**WARNING: do not wash dishware or table-ware contaminated with tobacco ashes, wax, paints and lubricants (engine oil).**

### END OF LIFE DISPOSAL

Electrical and electronic appliances often contain components, which are of value even upon the end of their service life. At the same time, the materials of these appliances also may contain hazardous substances required for operation and safety of the equipment above. Inadequate handling of time-expired appliances or their disposal as domestic waste may be very harmful both to human health and environment. Therefore, it is not advisable to dispose them as domestic waste.



We recommend you to send time-expired appliances to a licensed waste disposal and collection point.

Prior to sending an appliance for disposal, keep it away from children.

While preparing the product for disposal, unplug it, make the cable and plug inoperable (for which you can cut it, for instance), as well as the door lock. Doing this, you will prevent any further unauthorized use of the dishwasher that is subject to final disposal

### STORAGE

Keep the appliance in a dry place, away from sources of high temperatures and sunlight. During storage avoid rapid temperature changes. Storage of an unpackaged product is not permitted.

### TRANSPORTATION

Package dropping and any mechanical impact upon it are strongly prohibited.





## Warranty service conditions

The products are subject to free repair, if used only for personal, family or other needs, not related to business activities, or satisfying household requirements in an office of a company, institution or enterprise. The use of the products for purposes differing from above is deemed violation of the operation regulations.

The warranty certificate confers a right on free repair of the product within 12 months from the purchase date. Should you have any questions regarding the maintenance service, please contact the official representative of the brand. The contact details are on the web site of our partner [krona-steel.com](http://krona-steel.com). Within the warranty period defective parts of the products are subject to free repair or replacement with new ones. It is the Service Center that has to decide whether the defective products shall be repaired or replaced.

The service life of the product is 7 (seven) years. The service life starts on the purchase date. If it turns out to be impossible to determine the purchase date, the service life shall start on the manufacturing date, encoded in the product serial number which is on the manufacturer's plate.

The manufacturer's plate availability is an obligatory condition! Make sure it is available and keep it for the entire service life of the product. If it is not available, it may turn out impossible to determine the product model, manufacturing date. As a consequence, a request for a free repair may be declined.

The free repair is only possible with a properly and duly filled in warranty certificate, sale receipt for a product purchased, other documents to confirm the warranty period of the product submitted for repairs or diagnostics.

When buying a product, make sure the warrant certificate is duly filled in, contains no corrections and bears the purchase date, the stamp of a sales agency and signature of a sales assistant (includ-

ing a tear-off card), model and the serial number of the product.

Before you call a Service Center specialist, please carefully read the operation regulations. If the product turns out to be non-defective upon diagnostics performed by the specialist, the Service Center reserves the right to demand an ungrounded call payment from the customer, basing upon the current price list.

Any complaints with regard to quality of the components are subject to consideration only upon the quality inspection (technical condition inspection) to be conducted by a representative of the authorized Service Center.

The manufacturer shall not be liable for any damage to a customer or property of a customer and not be obliged to perform free repairs on the occurrence of any of the following:

- documents are missing to confirm the right for free repairs;
- repairs have not been performed by authorized persons, the product design has been changed, the product intervention is found, conflicting with the operation regulations;
- the operation regulations have been violated, stated in the product manual;
- installation regulations have been violated, as stated in the product manual;
- the product has not been timely serviced and maintained, as the product manual requires;
- the product has been connected to a water supply system, the water pressure of which differs from values specified in the product manual;
- the components and consumables have been replaced (accessories, lighting lamps\*, filters, remote control devices, water supply (without the aqua-stop system) / water drain hoses of

---

\* Except backlight lamps, unless its replacement procedure is described in the operation manual. It is only the replacement procedure that is free, not the lamp itself.

# DISHWASHERS

## Warranty service conditions

- dish-washing machines, accumulators, batteries, etc., plastic parts handled manually;
  - consumables have been used, of improper quality;
  - defects and damages have been found caused by extreme conditions and force majeure circumstances (fire, Acts of God, etc.);
  - impact of water and solutions upon mechanical and electrical components of the product;
  - negligent storage and / or negligent transportation have been proved;
  - damages (failures) of the equipment, its malfunction due to animals, insects and products of their vital functions;
  - excessive scaling upon the heating elements (with higher water hardness proper processing is required, using special preparations);
  - foreign matters inside the machine;
  - mechanical damage to the product (scratches, cracks, spalls, etc.);
  - loss of the saleable condition due to impact of chemicals;
  - use of cleaning / detergent agents, non-conforming to the type of the product;
  - thermal, mechanical and other damage of that kind that appeared while in operation;
  - the product uninstallation by a specialist of the Service Center turns out to be impossible (complex uninstallation procedures are subject to re-assignment to the company that has installed the product);
  - unintended use of the product;
  - the warranty terms and conditions have been violated, as stated in the warranty document.
- The following is not subject to warranty services: adjustments, installation, cleaning and connection.





[www.flavia-dishwasher.com](http://www.flavia-dishwasher.com)